



2 Storm Cottages Maidstone Road, Nettlestead – ME18 5HQ
Maidstone

Guide Price £325,000

bracketts
est. 1828



- First Floor Bathroom
- No Onward Chain
- Driveway to Front For 3-4 vehicles
- Character Cottage
- Front & Rear Gardens
- Arranged Over Three Floors
- In Need of Modernisation

Offered for sale to market for the first time in 40 years, now a blank canvass for full refurbishment is this two double bedroom character cottage situated in Nettlestead. Nettlestead is a picturesque village located near Maidstone. Nestled along the River Medway, known for its rural charm, historic buildings, and scenic surroundings.

Internally the property is in need of modernisation and accommodation comprises entrance, sitting room with feature fire place, dining room and fitted kitchen with exposed feature brick wall and vaulted ceiling. To the first floor there is a family bathroom and double bedroom. Stairs leading to second floor large bedroom. Externally the property offers both front & rear gardens and a driveway to the front for 3-4 cars. Set well back from road with long front garden, laid partially to lawn. Offered with no onward chain we recommend viewing at your earliest convenience.

Council Tax band: TBD

Tenure: Freehold





Maidstone Road, Nettlestead, Maidstone, ME18

Approximate Area = 1043 sq ft / 96.8 sq m

Limited Use Area(s) = 25 sq ft / 2.3 sq m

Total = 1068 sq ft / 99.2 sq m

For identification only - Not to scale

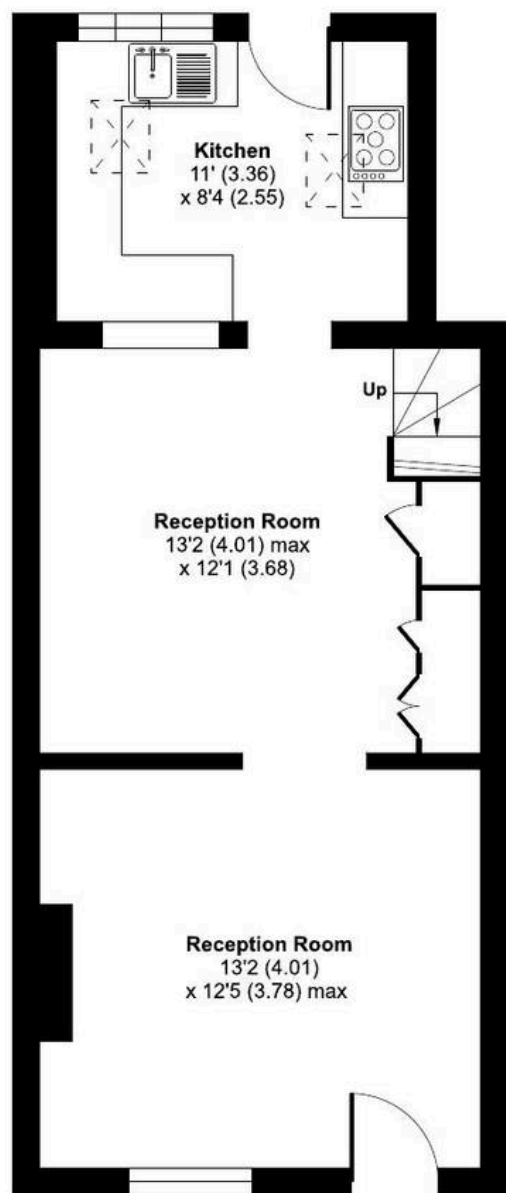

GROUND FLOOR

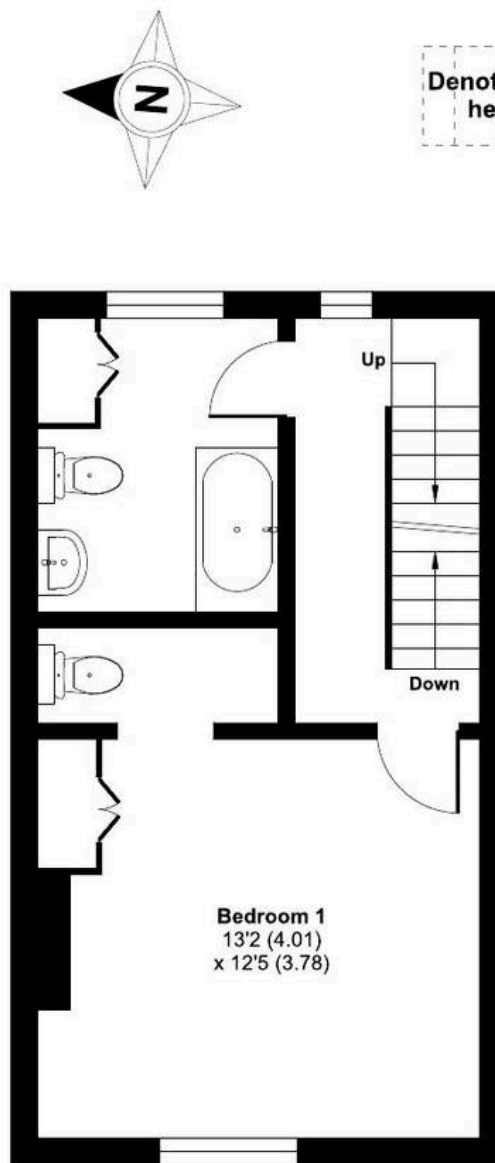

FIRST FLOOR

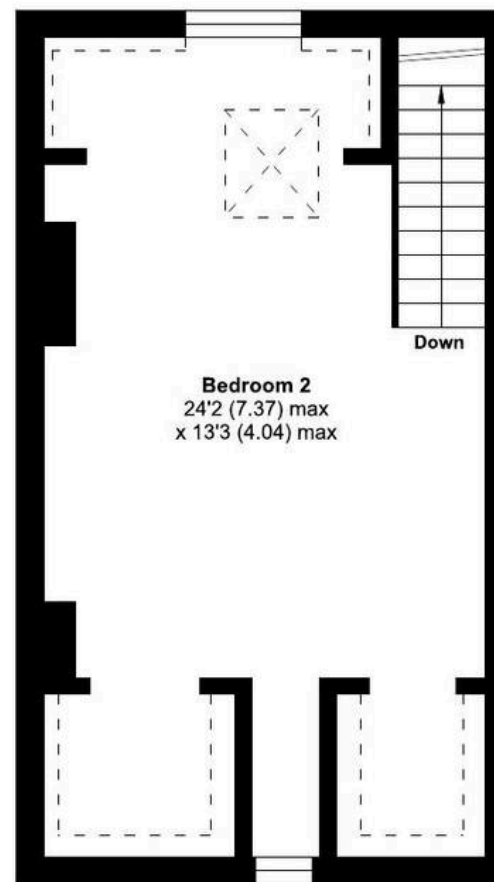

SECOND FLOOR



Denotes restricted
head height

