



Riverbank House, Angel Lane, Tonbridge, Kent, TN9 1SE

- MODERN STUDIO FLAT
- SPACE SAVING PULL DOWN BED
- COMMUNAL LIFT
- COUNCIL TAX BAND C
- OPEN PLAN LIVING/ BEDROOM
- WALKING DISTANCE TO MLS
- RIVERSIDE LOCATION



Rent £750 pcm



facebook.com/brackettscharteredurveyors

bracketts.co.uk

27 -29 High Street, Tunbridge Wells, Kent TN1 1UU
lettings@bracketts.co.uk

01892 533733

CHARTERED SURVEYORS • RESIDENTIAL & COMMERCIAL AGENTS • BUILDING SURVEYORS • VALUERS

A high specification second floor studio apartment with river views in central Tonbridge. The property comprises a luxurious kitchen with fitted appliances, spacious living/bedroom accommodation and a luxury shower room. The living room has a space saving foldaway bed that stores neatly in a cupboard. There is a communal lift to all floors. Situated within walking distance of the town centre and main line station.

The property can be provided furnished/ unfurnished. Available from 30th August.

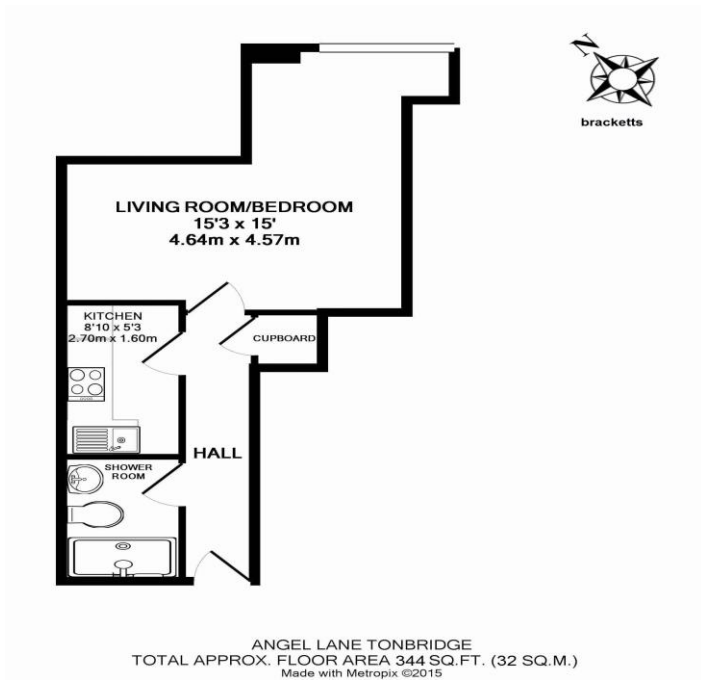

Energy Efficiency Rating		
	Current	Potential
Very energy efficient - lower running costs		
(92-100) A		
(81-91) B		
(69-80) C	73	73
(55-68) D		
(39-54) E		
(21-38) F		
(1-20) G		
Not energy efficient - higher running costs		
England, Scotland & Wales		EU Directive 2002/91/EC

Important Notice: Bracketts, their clients and any joint agents give notice that they have no authority to make or give any representations or warranties in relation to the property. These particulars do not form part of any offer or contract and must not be relied upon as statements or representations of fact. The text, photographs and plans are for guidance only and are not necessarily comprehensive. Any areas, measurements or distances are approximate. It should not be assumed that the property has necessary planning, building regulation or other consents and Bracketts have not tested any services equipment or facilities. Purchasers must satisfy themselves by inspection or otherwise. Prices, rents or any other charges are exclusive of VAT unless stated to the contrary.